

Datasheet

Banded earplugs

Protection against noise



Pura-Band®

6600

Jazz-Band®2

6700

Replacement pods

6825

CHARACTERISTICS

JAZZ-BAND®2



Jazz-Band®2

The convenient option against intermittent noise throughout the day.

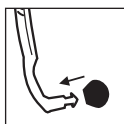

Replaceable pods

Soft PU-foam pods for more comfort - replaceable and hygienic.



Reduced noise transmission

Dual material technology reduces noise transmission.

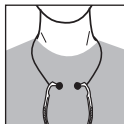

Cords

Neck cord with safety release mechanism allows the band to be worn around the neck during breaks.

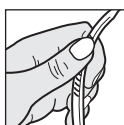

Rubber grip

Soft anti-slip rubber grips allows easy on and off application.

PURA-BAND®

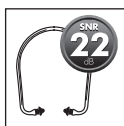

Pura-Band®

The cost effective option against intermittent noise throughout the day.

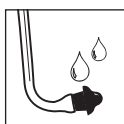

Washable pods

Durable pods made of soft thermoplastic - washable and hygienic.



100% PVC-FREE

All Moldex products and packaging are completely free from PVC.

CERTIFICATION

The Moldex range of hearing protection products meet the requirements of EN352-2 and are CE-Marked in accordance with the requirements of European Directive 89/686/EEC. Responsible for type examination (Article 10):

"Jazz-Band®2" and "Pura-Band®": IFA (0121) in St. Augustin (DE).

According to the German regulation BGR 194, the "Jazz-Band®2" and "Pura-Band®" fulfil the criteria "hearing of warning signals in general", "speech comprehensibility" and "signal hearing in track-system and road traffic possible".

ATTENUATION DATA

The Moldex range of hearing protection products passes the EN352-2 minimum attenuation requirements set out in the table below. The tables below show the full attenuation data for Moldex products.

6700 Jazz-Band®2

| Freq. (Hz) | 63 | 125 | 250 | 500 | 1000 | 2000 | 4000 | 8000 |
|---------------------|------|------|------|------|------|------|------|------|
| M _p (dB) | 22,3 | 21,9 | 20,4 | 19,0 | 22,0 | 31,4 | 39,8 | 41,8 |
| s _p (dB) | 5,0 | 3,9 | 4,0 | 4,5 | 3,4 | 4,5 | 4,3 | 7,0 |
| A.P.V (dB) | 17,3 | 18,0 | 16,4 | 14,5 | 18,6 | 26,9 | 35,5 | 34,8 |

Size: 9-14 H = 26 dB M = 19 dB L = 17 dB SNR = 23 dB

6600 Pura-Band®

| Freq. (Hz) | 63 | 125 | 250 | 500 | 1000 | 2000 | 4000 | 8000 |
|---------------------|------|------|------|------|------|------|------|------|
| M _p (dB) | 23.7 | 23.8 | 22.4 | 18.0 | 21.3 | 28.6 | 37.3 | 30.1 |
| s _p (dB) | 6.5 | 5.2 | 4.5 | 4.4 | 3.5 | 3.5 | 4.9 | 7.6 |
| A.P.V (dB) | 17.2 | 18.6 | 17.9 | 13.6 | 17.8 | 25.1 | 32.4 | 22.5 |

Size: 6-13 H = 24 dB M = 18 dB L = 17 dB SNR = 22 dB

Datasheet

Banded earplugs

Protection against noise



MATERIALS

Jazz-Band®2: Polyurethane, Polycarbonate, Polyester-cord

Pura-Band®: Thermoplastic Elastomere (TPE), Polypropylene

WEIGHT

Jazz-Band®2
6700: 18 g

Pura-Band®
6600: 11 g

TESTING

The banded earplugs of the Moldex Hearing Protection range have been tested to EN352-2 and fulfil all requirements of the relevant categories.

Ignitability

The banded earplugs shall not ignite upon application of a heated rod, nor continue to glow after the removal of the heated rod.

Construction

All parts of banded earplugs are designed and manufactured so that they are not liable to cause physical damage to the wearer when fitted and used according to the instructions.

INSTRUCTIONS FOR USE

- The products must be used in accordance with the relevant national legislation.
- Warning: disregarding the instructions for use and fitting instructions for these products can affect the product efficiency in protecting against noise.
- The products should be stored in a cool, dry environment.
- The products may be adversely affected by direct contact with certain chemical substances (e.g. aromatic hydrocarbons).
- The products are reusable provided the hygiene of the product is maintained between uses. Clean with mild soap and water.

INSTRUCTION FOR FITTING



1. Place band under chin and gently place the pods on the ear canal.



2. Ensure tip of pod is placed on the ear canal. Grasp top of ear, pull upwards and place pod on ear canal while moving back and forth.



3. Neck cord for work break (Jazz-Band®2)

INFO

For help on selection and training please contact us. We offer a wide range of training packages and support material.

MOLDEX-METRIC AG & Co. KG
Unit 9, Glaisdale Point
Off Glaisdale Drive, Bilborough
Nottingham. NG8 4GP

Tel.: +44 (0)115 985 4288
Fax: +44 (0)115 985 4211
www.moldex-europe.com
info@uk.moldex-europe.com